

GT4000

GT5000

GT6000

Overview



310 Sterling Industrial Road • Brunswick GA 31525 USA

912-264-1804 • 912-264-1844 Fax

www.grabber.com

GT4000 • 5000 • 6000 Truck System

TABLE OF CONTENTS

Specifications and Dimensions	3
Component Inventory and Descriptions	4-14
Repair Diagrams	15-16
Photo Gallery	17-23

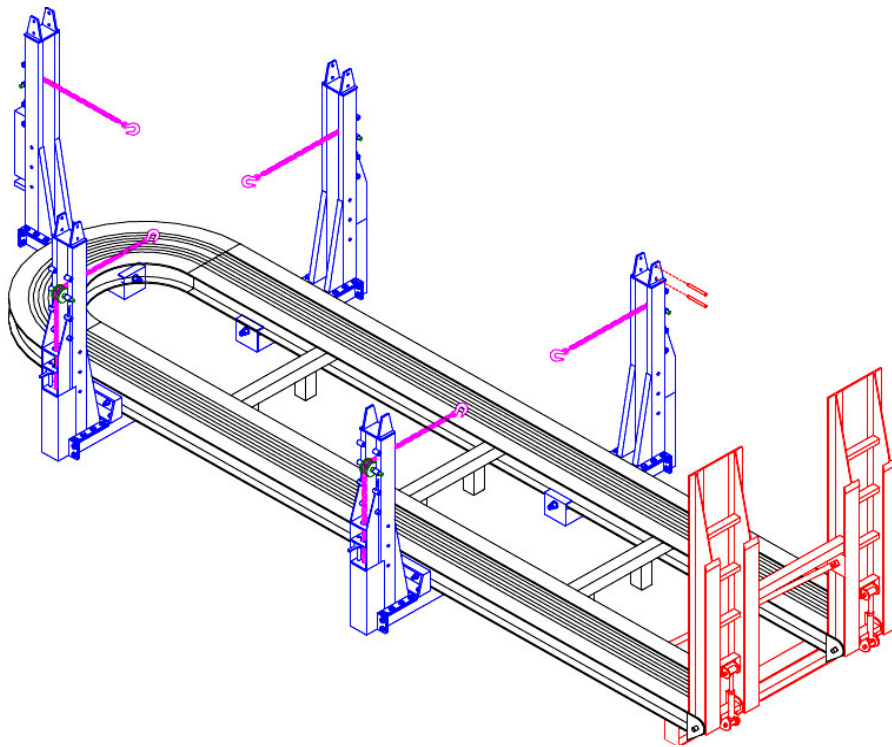

GT4000 • 5000 • 6000 Truck System

DIMENSIONAL SPECIFICATIONS

Platform Length (4000).....	40'	(12.19 m)
Platform Length (5000).....	50'	(15.24 m)
Platform Length (6000).....	60'	(18.29 m)
Platform Length (including towers) (4000).....	46'	(14.02 m)
Platform Length (including towers) (5000).....	56'	(17.07 m)
Platform Length (including towers) (5000).....	66'	(20.12 m)
Platform Width.....	8' 6"	(2591 mm)
Platform Width (including towers on each side)	14' 6"	(4420 mm)
Treadway Width	36"	(914 mm)
Center Opening.....	30"	(762 mm)
Tower Overhang	36"	(914 mm)
Tower Height.....	12'	(3658 mm)
Tower Height (from Floor to Top of Tower)	13' 6"	(4115 mm)
Hydraulics	25-Ton	
Ramp Length.....	10'	(3048 mm)
Height of Ramps (from platform) in the up position	9' 10"	(2997 mm)
Height of Ramps (from floor) in the up position	11' 6"	(3505 mm)
Working Height.....	20"	(508 mm)

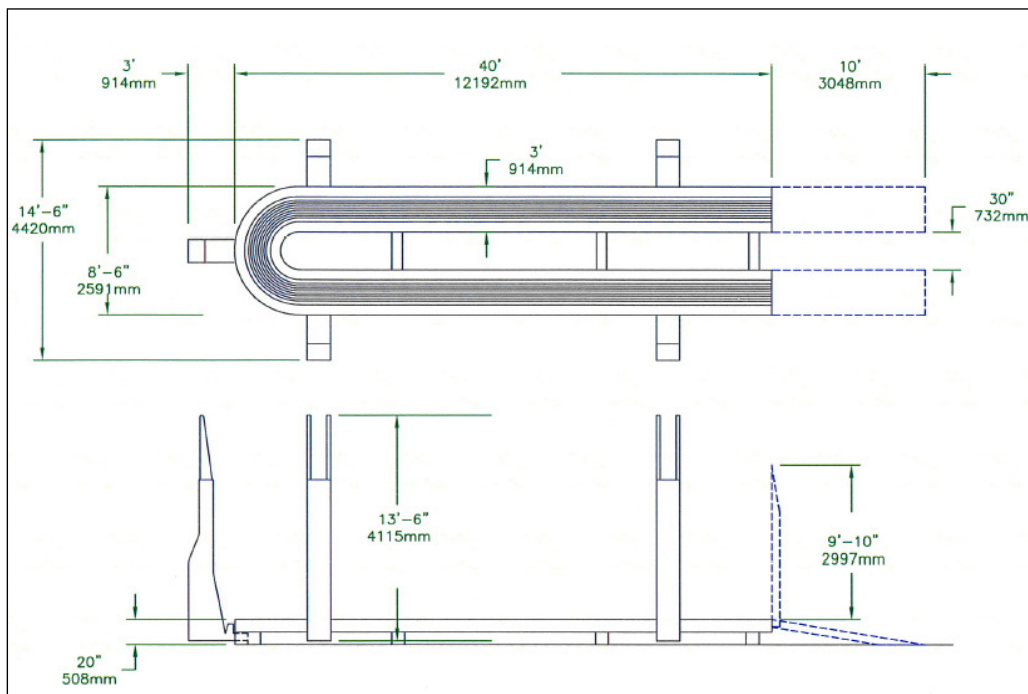

GT4000 • 5000 • 6000 Truck System COMPONENT INVENTORY & DESCRIPTION

25-Ton Pull Tower

Single Radius Platform (R)

Catalog #: GT101 Quantity: 4

Catalog #: GT101S Quantity: 1

Double Radius Platform (R2)

Catalog #: GT101 Quantity: 4

Catalog #: GT101S Quantity: 2

Mounted on gliding platforms, each tower can be easily moved into position. Pull towers feature a 4' roof pull extension, continuous pull capability, 25-Ton-14" stroke ram and cover for the hydraulics. A dedicated air/hydraulic pump with hose and gauge are also included. Swivel towers cover the radius portion of the platform only.

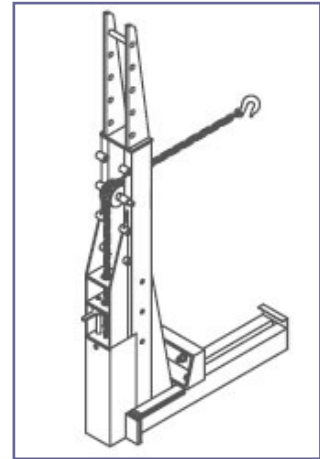

25-Ton Lift Stands Hydraulic

Catalog #: GT103 Quantity: 2

Air/hydraulic controlled, fully portable and can be placed anywhere that frame support or repair is necessary. A 25-ton-14" (355.60 mm) stroke RAM provides a height range of 26" - 40" (660.40 - 1016.00 mm). Lift stand may be used in conjunction with the floating crossmember and is especially useful for repairing frame twist.

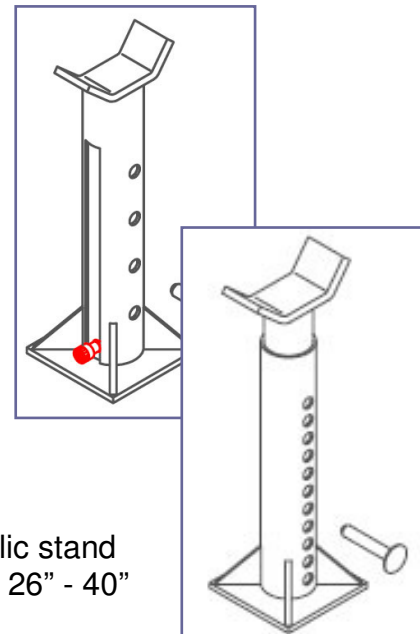

Adjustable

Catalog #: GT104 Quantity: 2

The adjustable stand has all the capabilities as the hydraulic stand except it adjusts manually. Height adjustments range from 26" - 40" (660.40 - 1016.00 mm) at 1-1/2" increments.

COMPONENT INVENTORY & DESCRIPTION

Portable Push/Pull Tower

Catalog #: GT149 Quantity: 1

Tower may be placed at any position along the treadways. Attachments allow the tower to push or pull with a 25-Ton RAM.

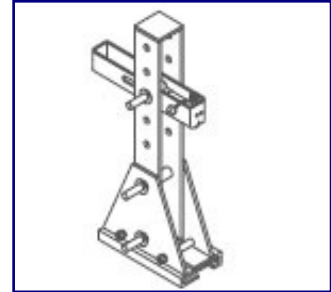

Down Pull Assembly

Catalog #: GT105 Quantity: 1

Clamps around the inside or outside treadway beam. Includes (1) 5/8" (15.88 mm) chain roller and one retainer pin.

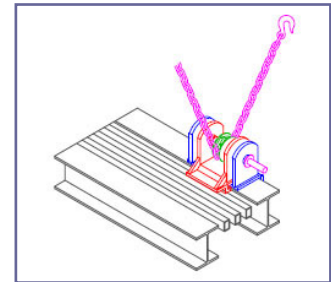

Chain Slack Remover

Catalog #: GT108 Quantity: 2

Removes chain slack to insure a solid tie-down point. Enables the pull tower to maximize its pull efficiency. Prevents the frame from 'skating' across the platform. Chain slack remover may be used at any location on the platform.

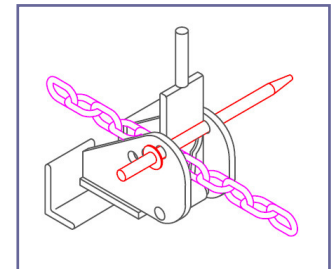

Rail Pull Tool Assembly

Catalog #: GT140 Quantity: 2

Consists of various parts that can be used in different combinations and configurations for pulling twist in rails and correcting upper and lower flange.

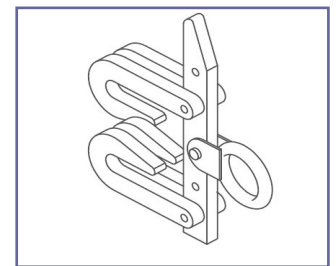

Heavy Duty Pull Plate

Catalog #: GT142 Quantity: 2

Use as a tie-down or pull tool when repairing a diamond. Attaches to the front or rear of frame rail.

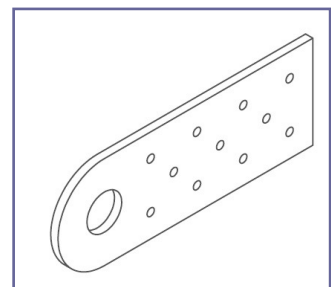

COMPONENT INVENTORY & DESCRIPTION

Power Block

Catalog #: GT109 Quantity: 1

Use to make multiple pulls with one tower. Doubles the power to effectively repair extensive frame damage.

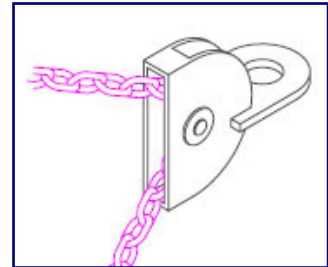

Outer Frame Hold Down

Catalog #: GT144 Quantity: 1

Use to anchor or pull lower flange or bottom of frame.

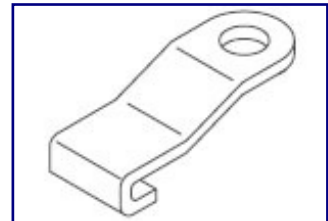

Portable Anchoring Plate

Catalog #: GT158 Quantity: 1

Use in conjunction with the heavy duty chain slack remover

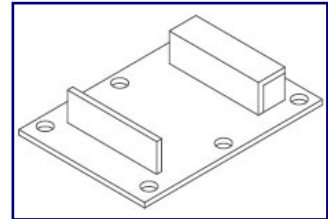

Flange Wrench Assembly

Catalog #: GT137 Quantity: 1 each

Multi-position flange wrench allows leverage to repair bent flanges. Includes head with a 1/2" opening, head with a 3/4" opening, and 36" handle.

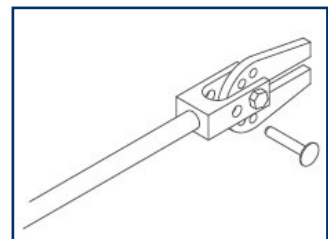

Arbor Press

Catalog #: GT143 Quantity: 1

Use to straighten bent flanges and repair bows in the channel web.

10-Ton direct press.

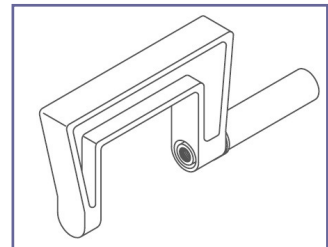



Frame Hold-Down with Roller

Catalog #: GT110 Quantity: 2

Use when pushing up on frame in order to hold frame in the down position.

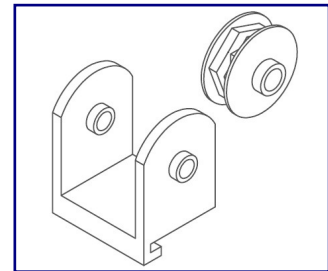

COMPONENT INVENTORY & DESCRIPTION

Chain Cradle

Catalog #: GT155 Quantity: 1 each
8" (203.20 mm); 10" (254.00 mm); 12" (304.80 mm)

Protects chain from unwanted kinks and binding when wrapping around the frame. Most effective when used in repairing a 'rainbow'.

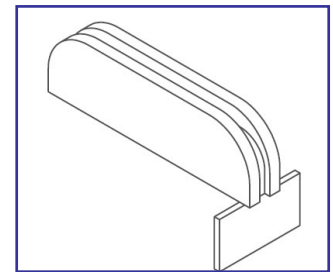

Floating Crossmember

Catalog #: GT160 Quantity: 2

Use with hydraulic and adjustable jack stands. May be positioned at any location on the treadway.

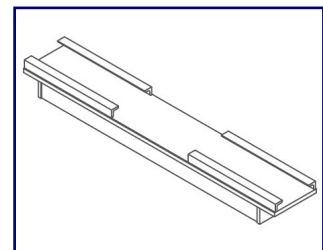

Chain Locks

Catalog #: GT192 Quantity: (10) For 5/8" chain (15.88 mm)

Catalog #: 1920 Quantity: (4) For 3/8" chain (9.53 mm)

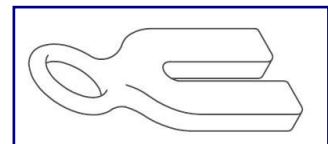

Use with all pull towers to enable continuous pulling.

Block Chain Anchor

Catalog #: GT194 Quantity: 2

To be used in conjunction with rail pull tool. May also be used with the power block to make multiple pulls with one tower.

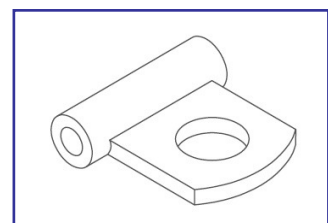

Air/Hydraulic Pump with Hose & Gauge, 10,000 PSI

Catalog #: 1351 Quantity: 1 per Tower



Operates all pulling and finishing components. Pumps feature a large, easy to read, liquid filled pressure gauge for the precise monitoring of pull pressure.

Air/Hydraulic Pump with Hose / No Gauge

Catalog #: 1350 Quantity: 1

Used to mobilize ramps.

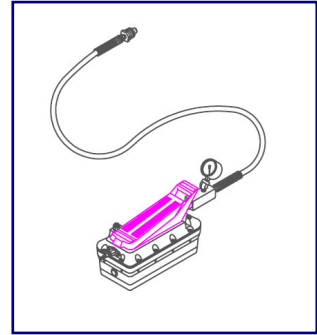

COMPONENT INVENTORY & DESCRIPTION

Chains

Catalog #: 1596 Quantity: 1 per Tower

Grade 80 5/8" x 15' (15.88 mm x 4.57m) with Slip Hook

Catalog #: 1588 Quantity: 2 each

Grade 80 3/8" x 20' (9.53 mm x 6.10m) with Slip Hook

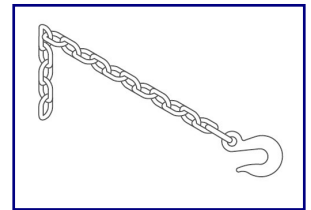

Nylon Strap

Catalog #: GT111 Quantity: 2

Used for pulling on the sheet metal structure of the cab.

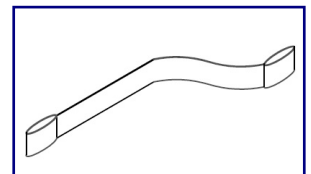

Hydraulic Ramps

Single Radius Platform (R)

Catalog #: 1055AR Quantity: 2

Heavy-duty 10' ramps are mounted on the square end of the platform and have built-in hydraulics which allows ramps to raise up when not in use.

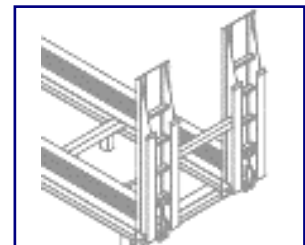

Double Radius Platform (R2)

Catalog #: GF200 Quantity: 2

Heavy-duty 10' ramps have hydraulically operated casters for easy mobility and may be stored away from the platform when not in use. Ramps attach to either end of the platform for drive-on/drive-off convenience.

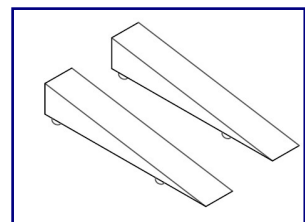

25-Ton Pull Tower w/RAM, #GT101

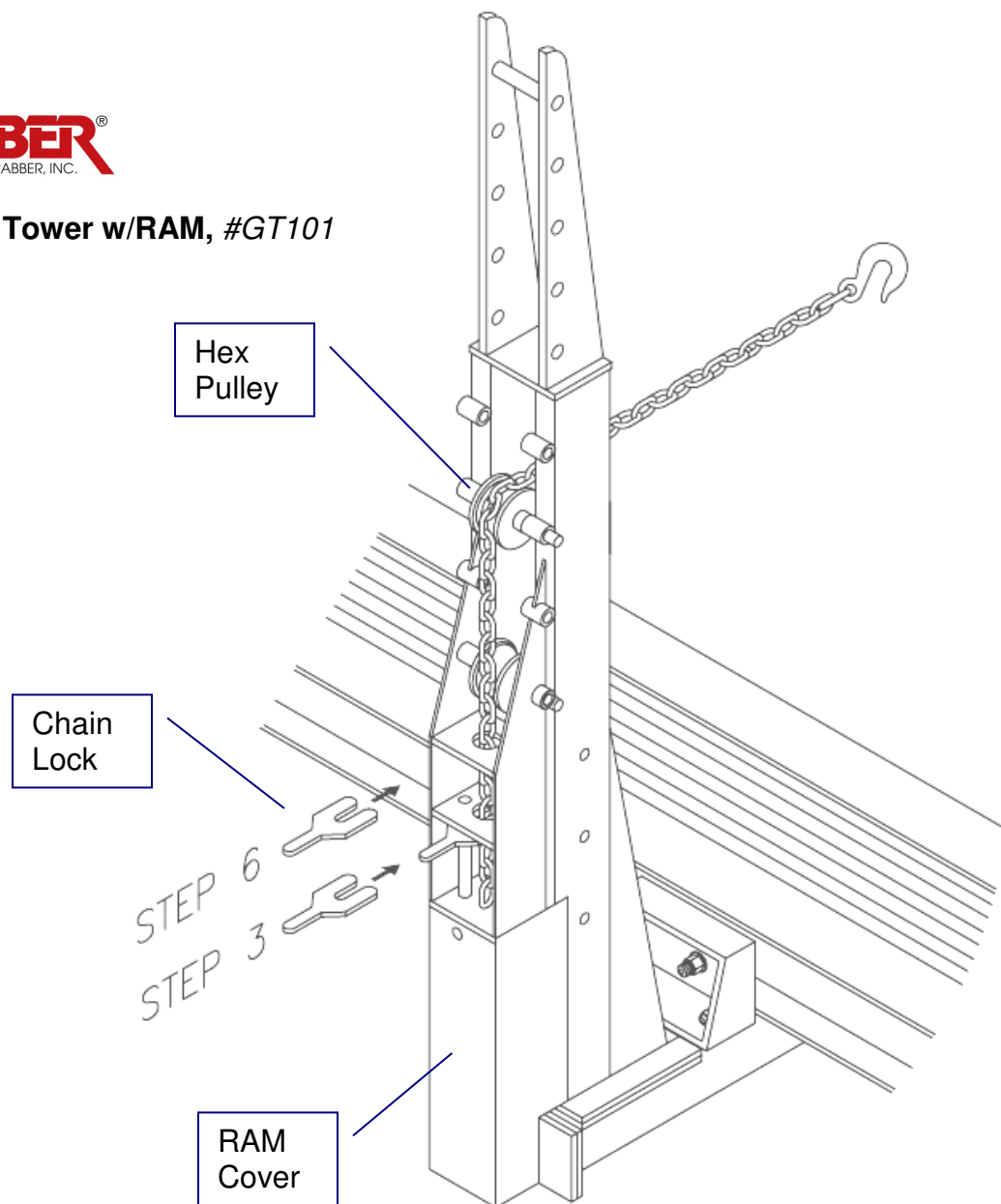

Step 1. Thread the pull chain over the top pulley and through the fixed plate and pull plate.

Step 2. Pull slack out of chain.

Step 3. Set the chain lock clip on the chain against the underside of the pull plate.

Step 4. Apply pressure to the RAM and make pull.

Step 5. For continuous pulls, with the RAM extended, install a second chain lock clip against the underside of the fixed plate in order to maintain chain tension.

Step 6. Relieve pressure. With RAM retracted, reset the chain lock clip as in Step 3.

Step 7. Proceed with second pull and repeat as necessary.



25-Ton Lift Stand (Hydraulic and Adjustable)

#GT103 & #GT104

Lift stands are fully portable. May be placed anywhere on the platform that frame support or repair is necessary. The **hydraulic stand** has a 25-Ton, 14" stroke RAM and provides for a height range of 26"-40". May be used in conjunction with the floating crossmember and is especially useful for repairing frame twist.

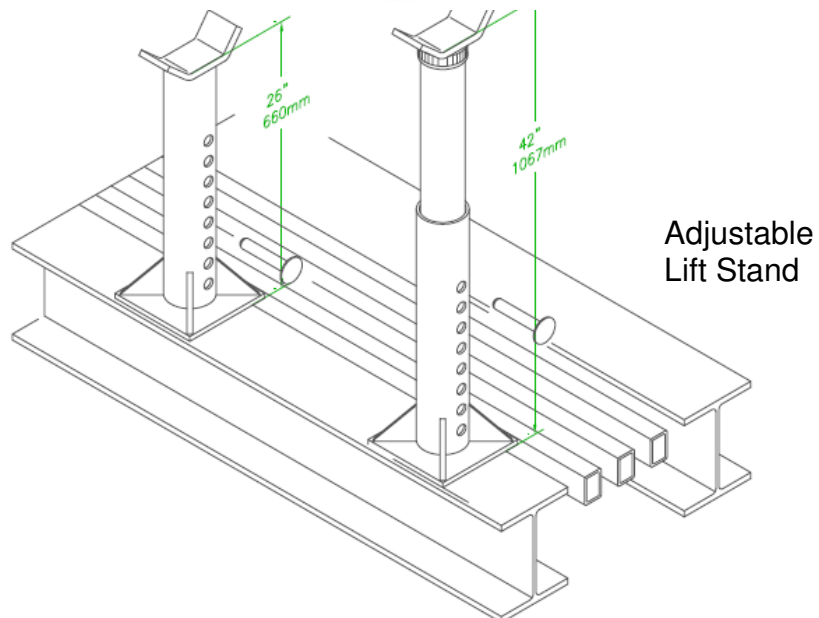
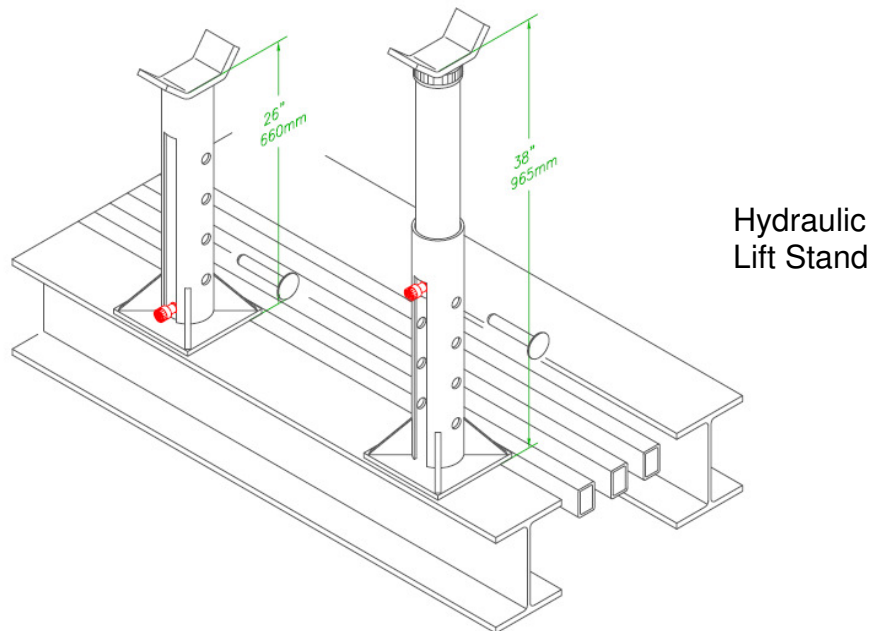

The **adjustable stand** has all the capabilities as the hydraulic stand except that it is adjusts manually. Height range from 6" - 42" at 1-1/2" increments.

Heavy Duty Down Pull Assembly
#GT105

Clamps around the inside or outside treadway beam.

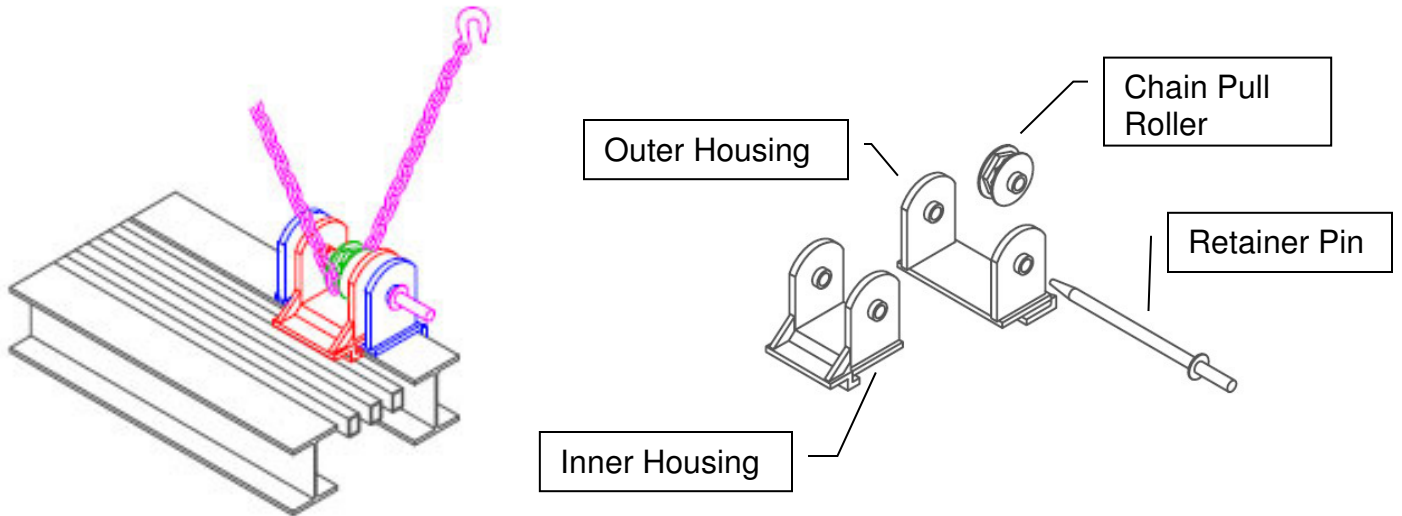

Inner housing and outer housing mate via the retainer pin and attach to the treadway.

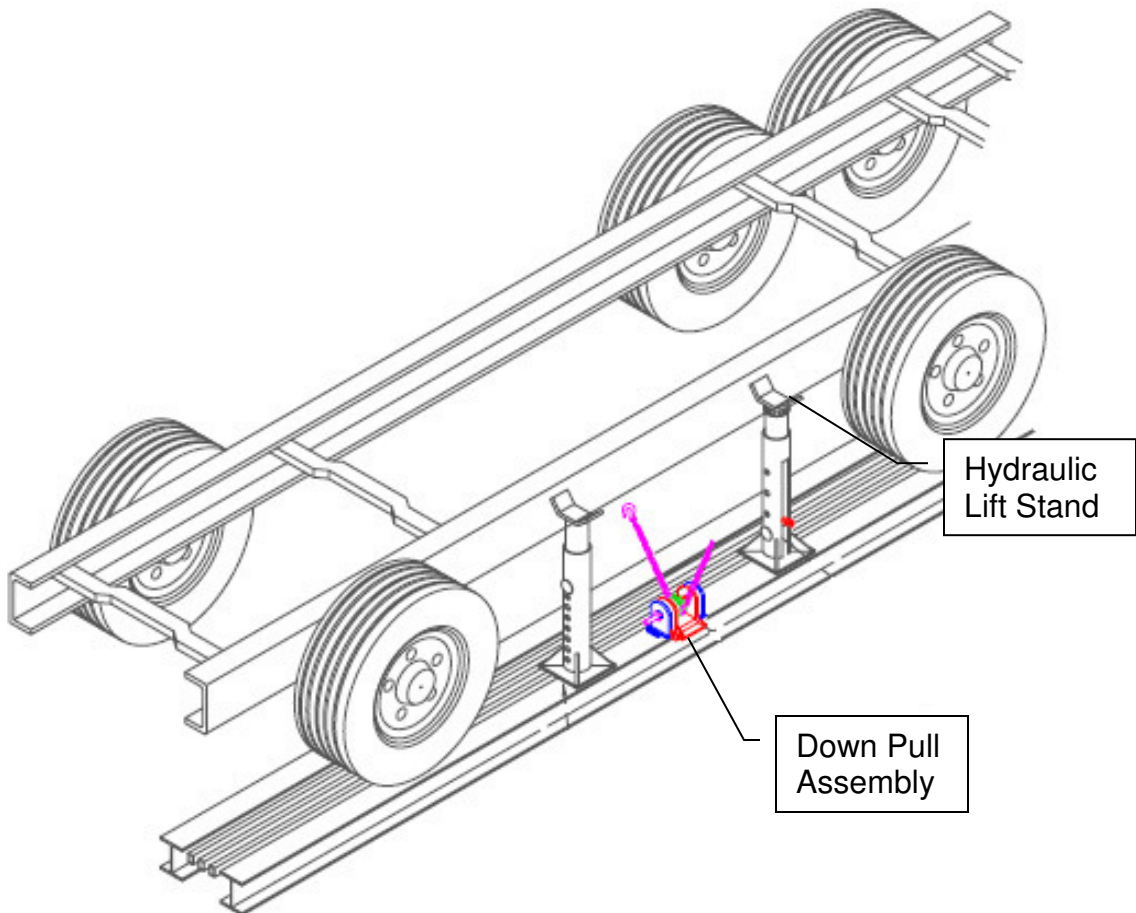

Heavy Duty Chain Slack Remover
#GT108

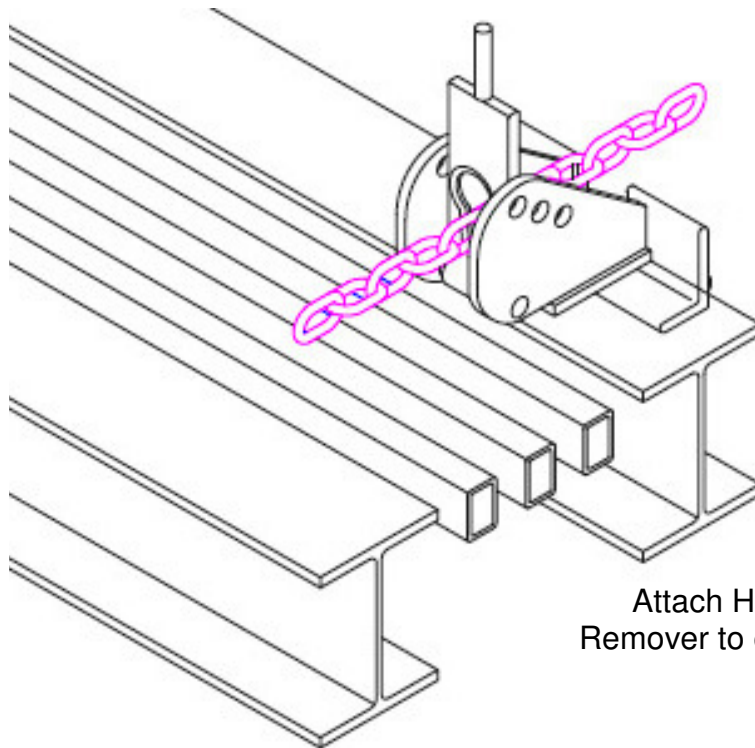
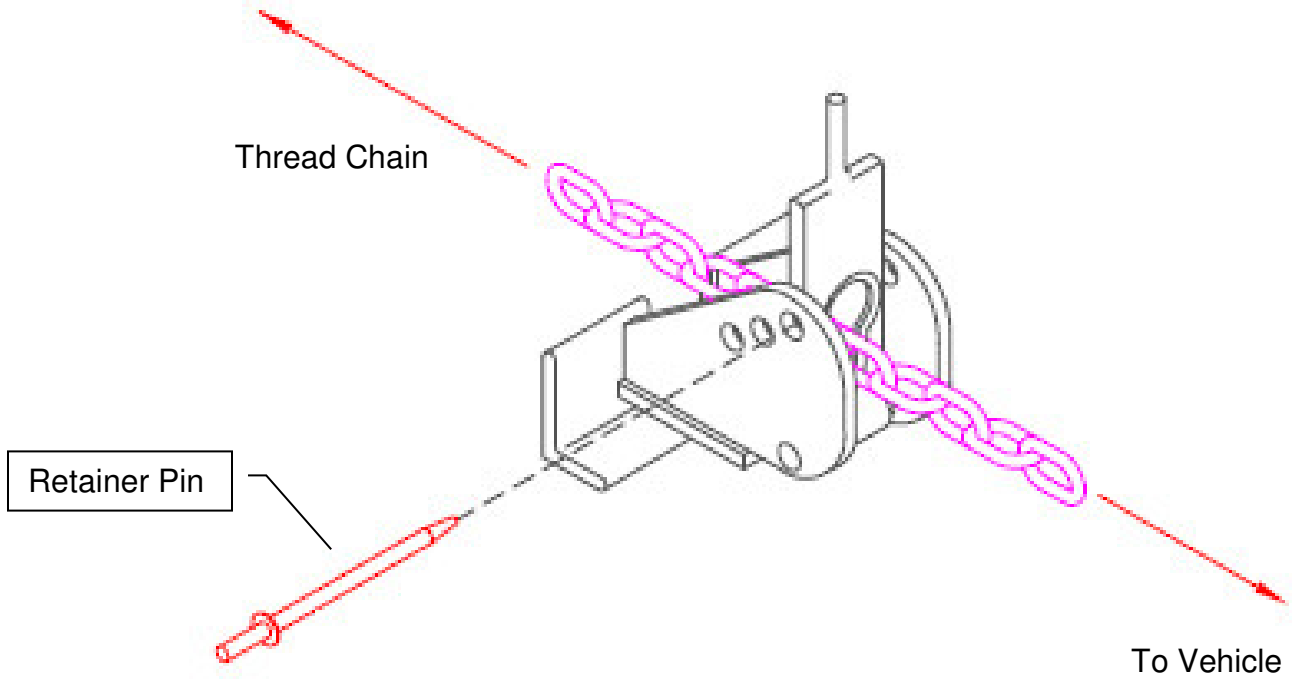

Attach Heavy Duty Chain Slack Remover to edge of rack treadway.

Power Block, #GT109

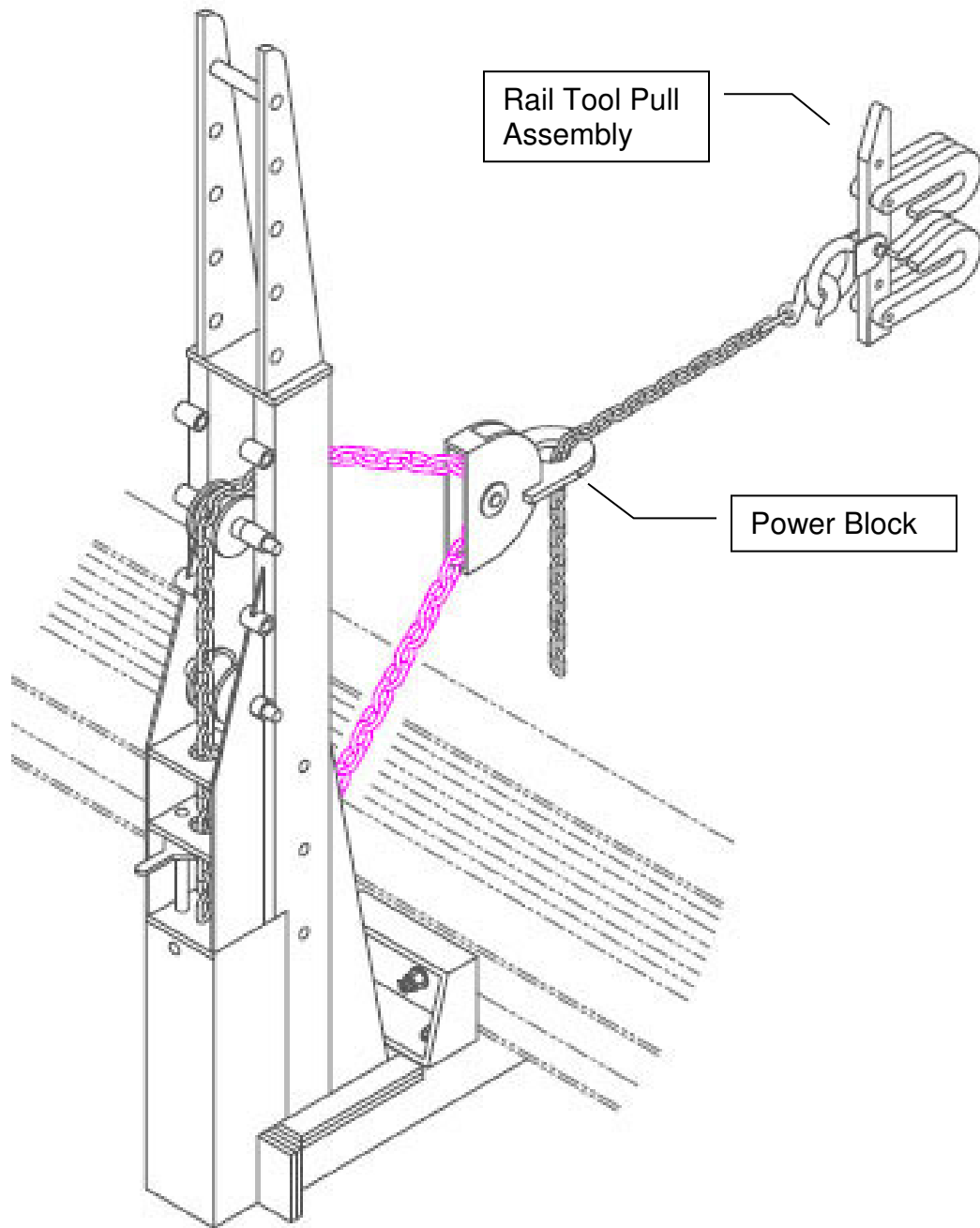

Heavy Duty Pull Plate, #GT142

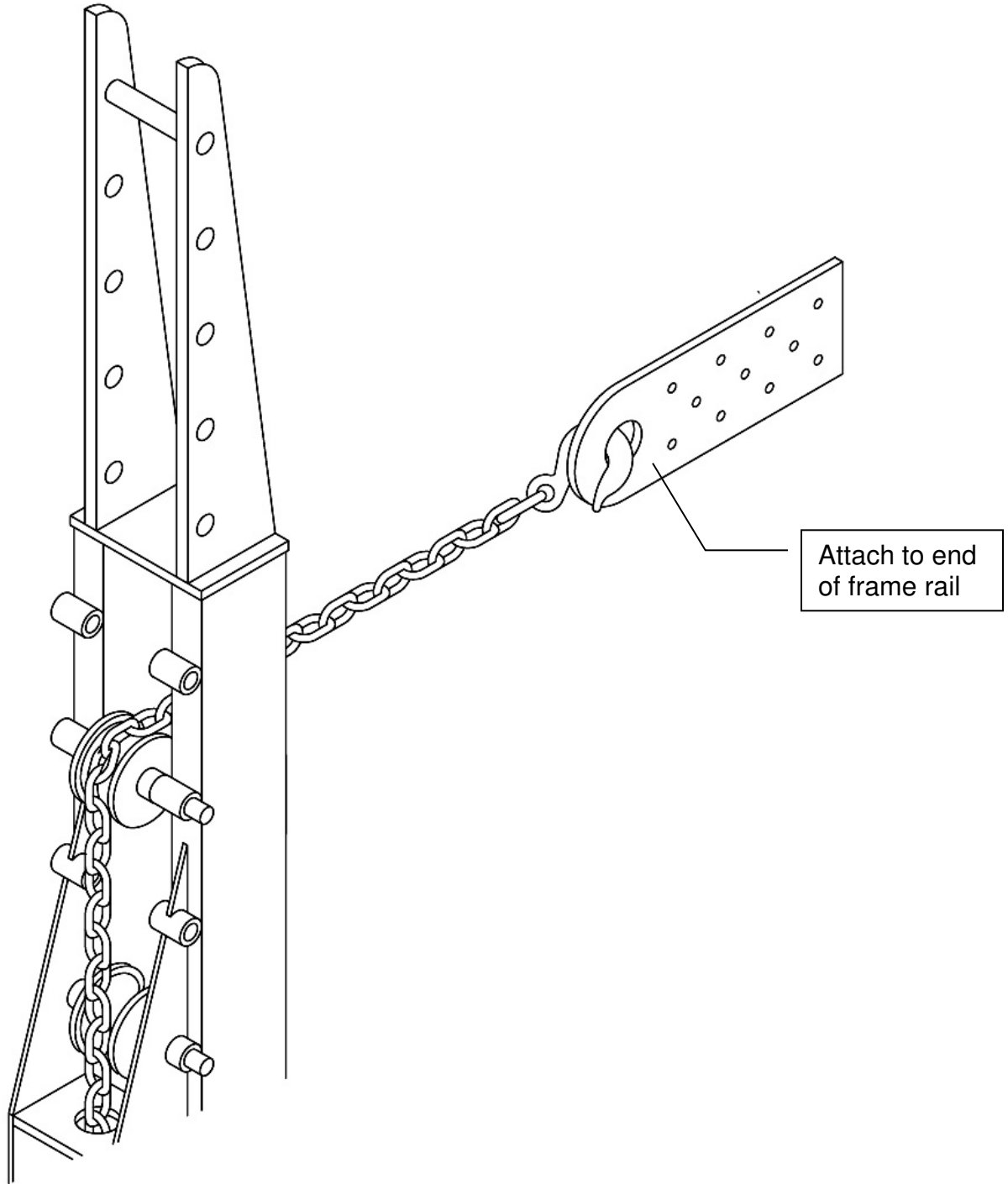

REPAIR DIAGRAMS

Repairing a Diamond

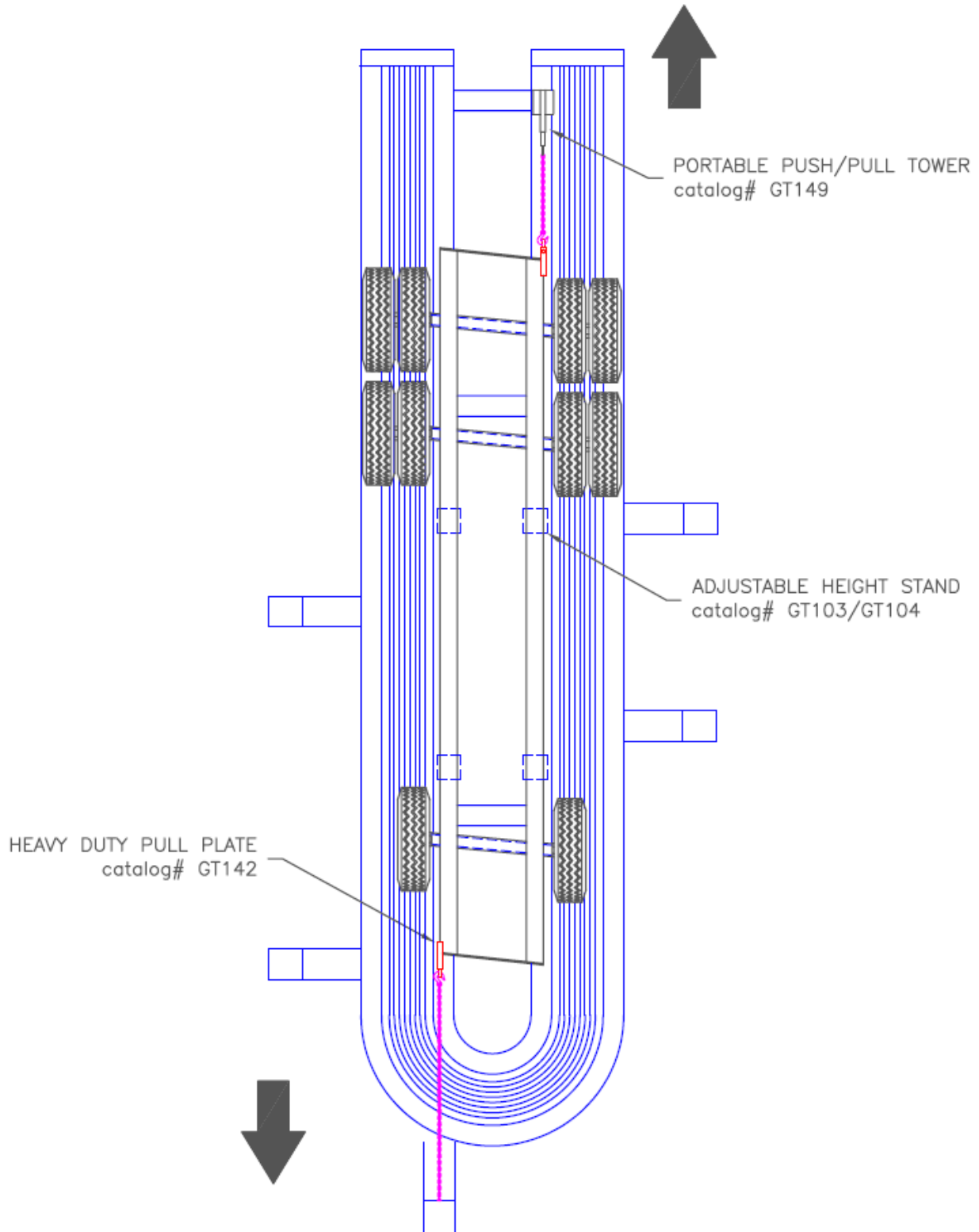

REPAIR DIAGRAMS

Repairing a Rainbow

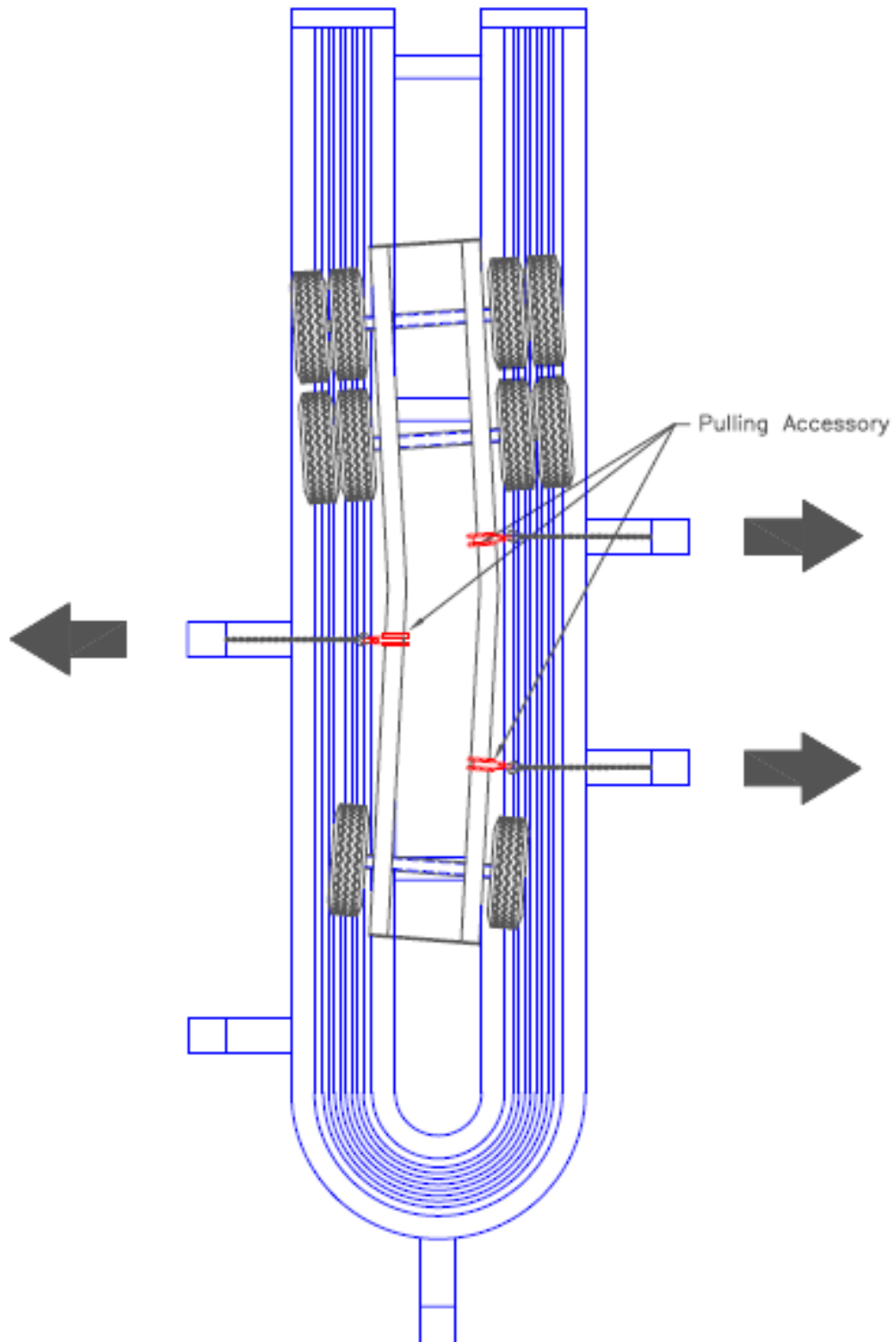

GT Truck System

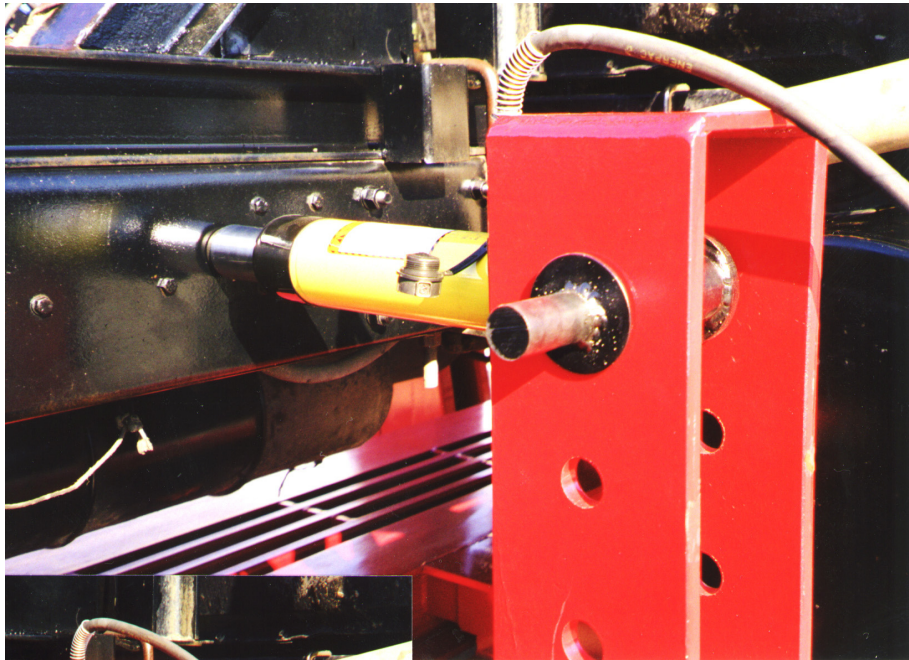

GT Truck System



GT Truck System

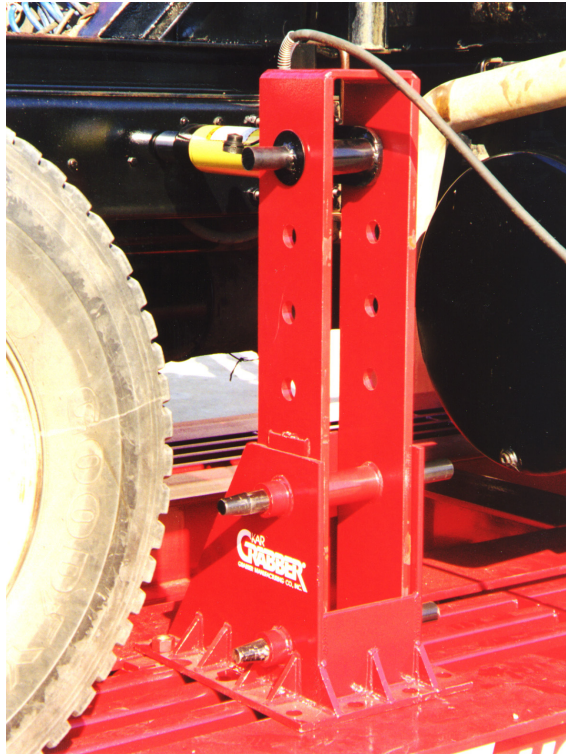

GT Truck System

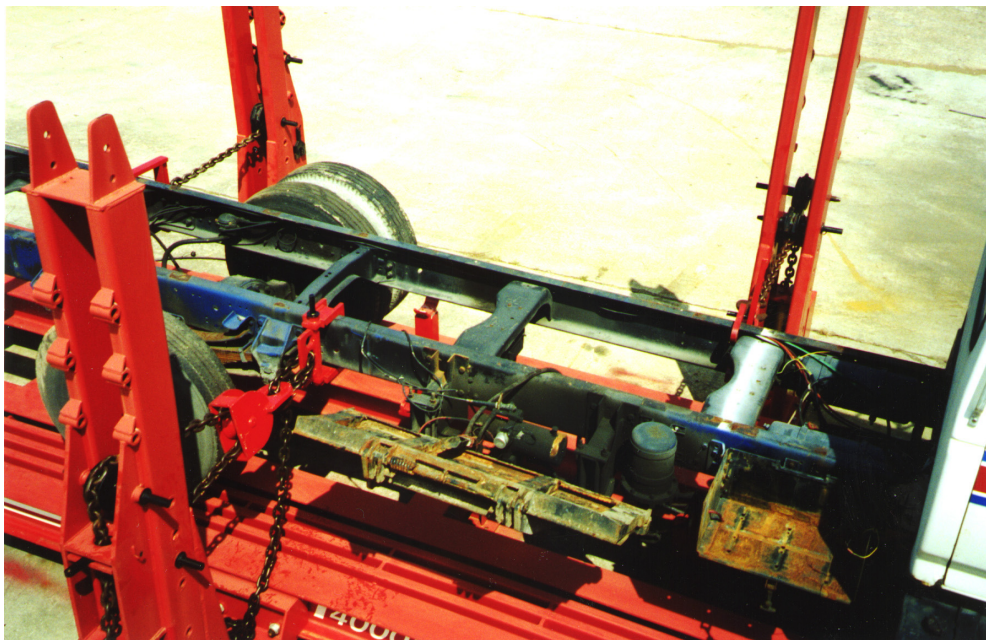
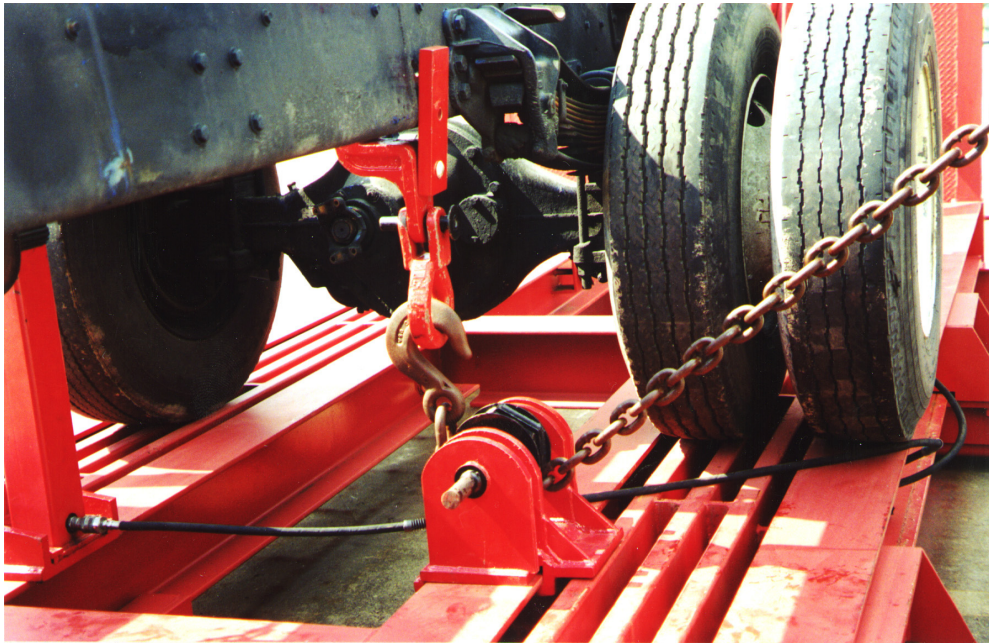

GT Truck System



GT Truck System

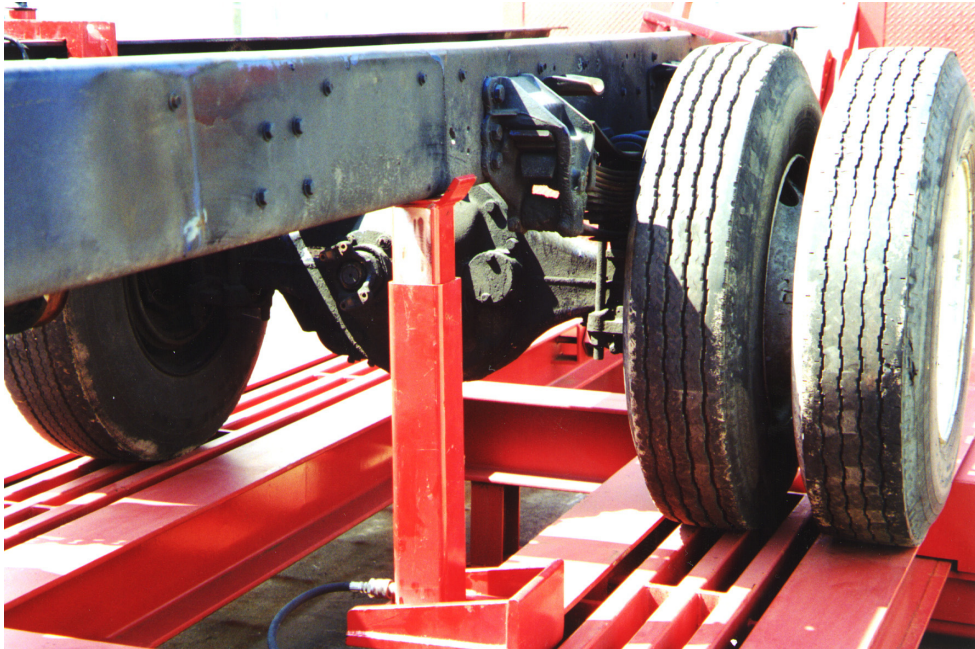

GT Truck System

